

INSTALLATION INSTRUCTIONS

Outdoor Wi-Fi Power Stake

MODEL: LH-7-1
ITM./ART. 1275483



Quick Start for CE Smart Wi-Fi Power Stake Setup:

1. Use your phone to scan the QR code below or search for "CE Smart" in the App Store or Google Play to download and install the App. For iPad's select "iPhone Only" option in the App Store to locate CE Smart App.



2. Connect mobile device to your 2.4GHz Wi-Fi network. Please note this Power Stake can only be connected via a 2.4GHz network.



3. Launch CE Smart and follow the in-app instructions to connect the Power Stake to your network.

a. Login to CE Smart

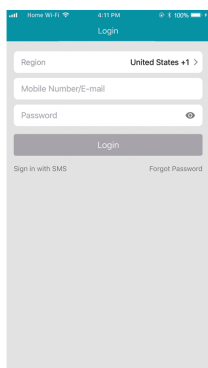

b. Click Add Device

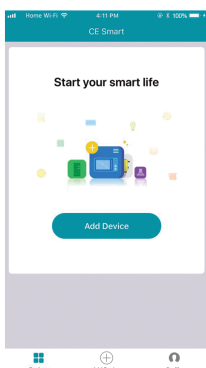

c. Set rapid blink, click Confirm

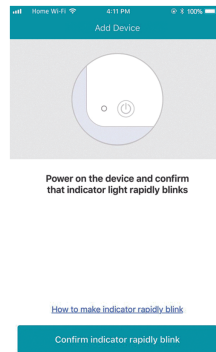

d. Enter Wi-Fi password

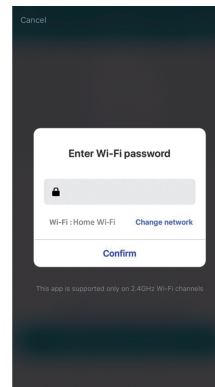

e. Connecting device

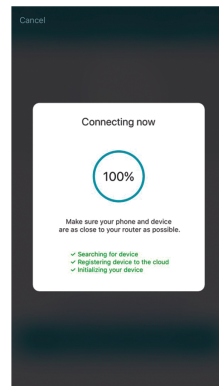

f. Edit Name, Share or Done

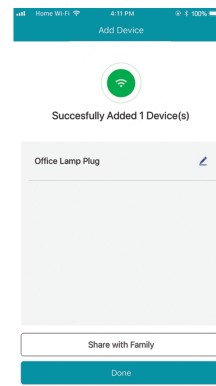

g. Device Home Screen

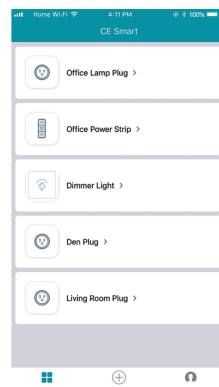

h. ON/OFF Control

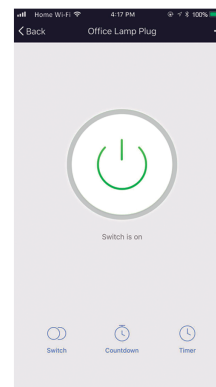

Wi-Fi Smart Power Stake:

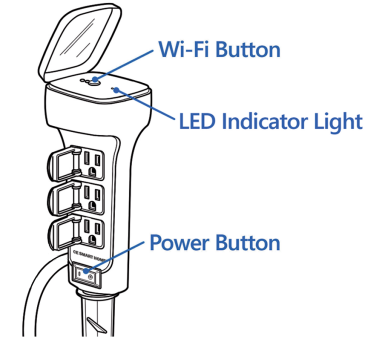

After you have successfully set up the CE Smart app and your device(s) you may control them remotely from your mobile device using a Wi-Fi or Cellular connection. Compatible with Amazon Alexa and Google Home.

LED Indicator Light:

Quick Flashing Blue - Connecting to the network
Slow Flashing Blue - AP Mode
Solid Blue - The Wi-Fi Stake is switched Off
Solid Red - The Wi-Fi Stake is switched On

CE Smart Reference Guide:

Register / Create an Account

- Tap "Register" to create an account using your email address or mobile phone number. Optionally you may tap Sign in with SMS to create a temporary account using your mobile phone number.
- Tap Register to enter registration page.
- The system automatically recognizes your Region (country/code). You may also follow the instructions to manually select your country code. Enter your email address or mobile number and tap Login (do not include dashes, spaces, or +1, only use 10 digit number).
- If you enter your 10 digit mobile number, you will get a verification code via text message. Enter the verification code, create a password, and tap "Confirm" to finish your registration.
- If you enter your email, create a password and tap "Confirm" to finish your registration.

Login / Registered Account

- Tap "Login" to sign in to your account.
- Enter your previously registered email address or mobile number and password, and then tap "Login."

Login / Temporary Account / Sign in with SMS

- Tap "Sign in with SMS" if you want to create a temporary login. Note: there is no password and your login account will not be saved.
- Enter your 10 digit mobile number (no dashes or spaces) and tap "Get." You will receive a verification code via text message.
- Enter the verification code and tap "Login."

Forgot Password

- To reset Password, Tap "Forgot password."
- Enter your email address or mobile number and tap "Next."

INSTALLATION INSTRUCTIONS



- Enter the verification code received via text or email, then enter a new password, tap "Confirm" to finish.

Add Device + Normal Mode

- Enter the app, tap "+" Add Device in the centre bottom of the page to enter device connection page.
- There are two Wi-Fi network connection methods (Normal Mode and AP Mode). Normal Mode is the default and connects via your 2.4GHz Wi-Fi channel only. (Does not work with 5GHz channel.) Normal mode allows you to connect several CE Smart devices at the same time.
- For Normal Mode, please make sure the indicator light on the Power Stake is set to flashing rapidly (2 times per second).
- Press power button to turn on device, press again to turn off device.
- Press the Wi-Fi button and hold for 10 seconds until blue indicator light starts rapid flashing. If steady red light turns back on again, press and release button to get blue light quickly flashing.
- Tap "Confirm indicator rapidly blink."
- Enter your 2.4GHz Wi-Fi password and tap "Confirm" to enter the device connection process.
- Device Connection Process will begin and connect device.
- Tap Done.

AP Mode (Access Point)

- Tap "AP Mode" in upper right screen.
- Connect your phone to 2.4GHz Wi-Fi.
- In AP Mode your device broadcasts a device name in your phone's Wi-Fi settings that allows the Wi-Fi device to connect to your network. AP mode allows you to connect devices one by one.
- Make sure the device's indicator light is slowly flashing (1 time every 3 seconds). Press Wi-Fi power button to turn on device, press again to turn off device. Press and hold Wi-Fi power button for 10 seconds to set blue indicator light to fast flashing. Press and hold again until blue indicator light slowly flashes.
- Tap "Confirm indicator slowly blink."
- Enter your 2.4GHz Wi-Fi password and tap "Confirm."
- Open Wi-Fi Settings to connect to Device's Access Point Wi-Fi name.
- Locate then Tap the Wi-Fi device name, i.e. SmartLife_XXXX.
- Tap Connect.
- Go back to CE Smart app.
- Device Connection Process will begin and connect device.
- Tap Done.

Network Connection Process

The app goes through the process of trying to Connect Device, and displays a percentage on the Connecting Now screen while connecting. When the percentage reaches 100% the device should be successfully connected and registered to the cloud. The device default name will appear on the screen. You may rename the device by tapping the pencil icon to edit. This allows you to change to a better description of what the Power Stake is controlling, for example, "Holiday Decorations." Tap "Done" or "Share with Family" to finish setup.

Troubleshooting Adding Device Failed

If your app interface failed to connect your stake to your mobile device, it means that the network connection failed. Make sure you are connected to a 2.4GHz Wi-Fi channel, you entered the correct Wi-Fi password, and the Blue light is quickly flashing. Try connecting again or view help in the app. Try connecting inside first then move the stake outside.

Not all Wi-Fi installations are the same. If you are having trouble getting the light to fast blinking when setting up your device on your Wi-Fi, do

not give up. Try these steps several times repeatedly until you get the light to fast blinking.

Controlling Devices

After successful configuration, the connected devices will be displayed on the home screen. Tap the device name to enter its control page.

Access to the control buttons is located in the upper right corner of the screen "...". In addition to Switch, Countdown and Timer on main screen. Note: When device is offline or no longer connected, "Offline" will instruct you to re-connect the device.

Device Control Center Features

- **Switch:** Switch the outlet on and off remotely using Wi-Fi or Cellular connection.
- **Countdown:** Set a countdown timer to set your device to either turn on or turn off once.
- **Timer:** Set on and off schedules for each device. On and off schedules must be set up individually. Make sure to set an off schedule for every on schedule.

Device Settings / ...

To control your devices Tap "...". In upper right corner of device control screen.

- **Modify Device Name**> Set a custom name for your device.
- **Check the Network**> Check your network connection.
- **Use Amazon**> Follow the on-screen instructions for how to set up Amazon Alexa voice control of your devices with the Amazon Alexa app and an Amazon Echo device.
- **Use Google Home**> Follow the on-screen instructions for how to set up Google Assistant voice control of your devices with the Google Home app and a Google Home device.
- **Device Sharing**> Tap "Add" to share the device with family members; they must have registered CE Smart app login name.
- **Device Info**> Displays your Device ID, IP address and Mac Address.
- **Create Group**> Create a group to control multiple devices simultaneously. A list of available devices to group will be displayed. Only identical devices with same model number may be grouped.
- **Send Feedback**> Send feedback to the manufacturer.
- **Check for Firmware Update**> Display the latest version.
- **Remove Device**> Remove the device from the app. Note: this won't delete the customized device information; previously connected device information is stored.
- **Restore Manufacturer Defaults**> Delete the stored device information completely.

Profile

Tap "Profile" located at bottom of home screen.

Tap to set your name> Below are options available for set up:

Add Profile Picture, Nickname, Phone Number, Account location, Temperature Unit, Time Zone, Change Login Password, Pattern Unlock, Logout

Device Sharing> Users sharing your device.

Message Center> Messages related to the app.

Integration> Display list of supported devices and set up instructions for Amazon Echo and Google Home Devices

Scan QR Code> QR code scanner

FAQ> Tap to view list of frequently asked questions

Feedback> Display feedback messages sent or send new feedback message.

About> Current app version. Rate Us: submit rating and/or review.

Settings> Turn on/off Sound, Vibrate, and Push Notifications, Clear Cache.

SPECIFICATIONS

Maximum Input Voltage (VAC)	125 VAC
Nominal Input Frequency (Hz)	60Hz
Maximum Output Power (Watts)	1875W
Maximum Line Current (Amps) Tungsten Load	15A
Indoor	Indoor and Outdoor
Network Requirements	Wireless router supporting 2.4 GHz wireless band
Remote Control Devices through 3G, 4G or Wi-Fi	Android smartphone device running Android 4.1 or above
Smart Device Compatibility	iPhone/iPad running iOS 8 or above
CE Smart App 2.3.0 or higher	
Environmental Humidity	85% Maximum
Certifications	ETL & CETL Listed, FCC, IC
Standards	Conforms To UL Std. 2438 and 60730-1 Certified To CSA Std.C22.2#308 and E60730-1
FCC ID	2AMQ8-WIFI-007
IC	23878-WIFI007

FCC Compliance:

This device complies with part 15 of the FCC rules and the Industry Canada license-exempt RSS standard(s). Operation is subject to the following two conditions: (1) this device may not cause interference, and (2) this device must accept any interference, including interference that may cause undesired operation of the device.

Changes or modifications not expressly approved by the party responsible for compliance could void the user's authority to operate the equipment.

This equipment has been tested and found to comply with the limits for a Class B digital device, pursuant to part 15 of the FCC Rules. These limits are designed to provide reasonable protection against harmful interference in a residential installation. This equipment generates uses and can radiate radio frequency energy and, if not installed and used in accordance with the instructions, may cause harmful interference to radio communications. However, there is no guarantee that interference will not occur in a particular installation. If this equipment does cause harmful interference to radio or television reception, which can be determined by turning the equipment off and on, the user is encouraged to try to correct the interference by one or more of the following measures:

- Reorient or relocate the receiving antenna.
- Increase the separation between the equipment and receiver.
- Connect the equipment into an outlet on a circuit different from that to which the receiver is connected.
- Consult the dealer or an experienced radio/TV technician for help.

This equipment complies with Canada radiation exposure limits set forth for an uncontrolled environment. This equipment should be installed and operated with a minimum distance of 20cm between the antenna of this device and your body.

Conformité FCC :

Cet appareil est conforme à la partie 15 des règles de la FCC et aux CNR d'Industrie Canada concernant les appareils radio exempts de licence. Son fonctionnement est assujéti aux deux conditions suivantes : (1) cet appareil ne doit pas provoquer d'interférence; (2) cet appareil doit accueillir toutes interférences, y compris celles pouvant nuire à son fonctionnement. Cet appareil est conforme à la norme CNR-247

INSTALLATION INSTRUCTIONS

d’Innovation, Sciences et Développement économique Canada. Son fonctionnement est assujéti à la condition qu’il ne puisse pas provoquer d’interférence nuisible. Tout changement et toute modification non expressément approuvés par l’entité responsable de la conformité peuvent annuler l’autorisation d’utiliser cet appareil.

Cet appareil a fait l’objet d’essais et répond aux critères d’un appareil numérique de classe B, en vertu de la partie 15 des règles de la FCC. Ces critères visent à garantir une protection suffisante contre les interférences nuisibles dans une installation domestique. Cet appareil génère, utilise et peut émettre de l’énergie de fréquence radio et, s’il n’est pas installé et employé conformément aux instructions, il peut provoquer de l’interférence nuisible aux communications radio.

Toutefois, rien ne peut garantir qu’une quelconque installation ne produira aucune interférence. S’il advient que cet appareil cause une interférence nuisible à la réception des signaux de radio ou de télévision, ce qu’on peut confirmer en allumant et en éteignant l’appareil, l’utilisateur peut essayer les mesures suivantes pour éliminer l’interférence :

- réorienter ou déplacer l’antenne de réception;
- augmenter la distance entre l’appareil et le récepteur;
- brancher l’appareil et le récepteur sur des circuits différents;
- consulter le revendeur ou un technicien qualifié en radio/télévision pour obtenir de l’aide.

Cet équipement est conforme aux limites canadiennes d’exposition aux rayonnements établies pour un environnement non contrôlé. Cet équipement doit être installé et utilisé de façon à ce qu’il y ait un minimum de 20 cm de distance entre son antenne et les personnes qui l’entourent.



WARNINGS

CAUTION – Risk of Fire. Not for permanent installation. Use only with outdoor equipment, Christmas-tree, or other seasonal decorative-lighting products having a total of 12 Ampere maximum. Do not install or use this product for more than a 90-day period.

If using Christmas tree or decorative-lighting products that are not marked with an ampere rating, connect no more than 140 screw-base lamps (C7 or C9) or 12 strings with midget (pushin) lamps to this cord set.

Cord sets shall be plugged into a GFCI-protected receptacle.

If using an outdoor-use cord set for an extended period of time (greater than 90 days) please consider hard wiring a permanent outdoor-use receptacle rated for year-round use in the area that power is needed. Please contact a Licensed electrician for proper installation of permanent wiring.

After completion of installation, the silver connector ring shall be maintained a minimum of 6 inches above ground.

SUITABLE FOR OUTDOOR USE, WET LOCATION. STORE IN DRY LOCATION WHEN NOT IN USE

WARNING: The outdoor seasonal-use cord-connected wiring device could turn on unexpectedly without the user being present. To Reduce the Hazardous Condition - Unplug the appliance that is plugged into the receptacles of the device before servicing

DANGER: ELECTRICAL CORDS CAN BE HAZARDOUS- Misuse can result in FIRE or DEATH by ELECTRIC SHOCK

Inspect cord thoroughly before use. DO NOT USE IF DAMAGED

Look for the NUMBER OF WATTS on appliances to be plugged into unit. DO NOT plug more than the specified wattage. DO NOT exceed recommended electrical ratings

DO NOT run cord through doorways, holes in ceiling, walls or floors

Make sure appliances are OFF before connecting cords to outlet

FULLY INSERT plug into Outlet

DO NOT remove, bend, or modify any metal prongs or pins on cord

DO NOT use Excessive force to make connections

DO NOT connect a three-prong plug to a two hole cord

DO NOT plug one extension cord into another

AVOID OVERHEATING- Uncoil cord and DO NOT cover with any materials

DO NOT drive, drag, walk on, or place objects over cord

DO NOT unplug by pulling cord, always unplug when not in use

DO NOT immerse in water

Always store device indoors

Keep children and pets away from cords

DO NOT use with precision timing devices where inaccurate timing could be dangerous

DO NOT use with devices that should not be operated unattended (heaters, burners, etc.)

ATTENTION : risque d’incendie. Ce produit n’est pas destiné à une installation permanente. N’utiliser qu’avec des appareils pour l’extérieur et des lumières ou accessoires décoratifs temporaires (comme des décorations de Noël) n’exigeant pas plus de 12 ampères. Limiter l’utilisation de ce dispositif à des périodes de 90 jours.

Si aucune indication de l’intensité (ampères) ne se trouve sur les lumières ou accessoires décoratifs, ne pas brancher plus de 140 ampoules à culot à vis (C7 ou C9) ou 12 sections de mini-ampoules à ce dispositif.

Le cordon doit être branché à une prise protégée par DDFT.

Pour une utilisation extérieure prolongée (plus de 90 jours), on recommande l’installation de câblage et de prises extérieurs conçus pour une utilisation permanente à l’endroit où le courant est nécessaire. Communiquer avec un électricien qualifié pour l’installation adéquate d’un câblage permanent.

Une fois le dispositif installé, les prises doivent se trouver à au moins 6 pouces (15 cm) du sol.

PRODUIT ADAPTÉ AUX CONDITIONS EXTÉRIEURES HUMIDES. RANGER DANS UN ENDROIT SEC LORSQU’IL N’EST PAS UTILISÉ.

Pour installation extérieure temporaire. Limiter l’utilisation à des périodes de 90 jours.

ALL CHARGING ESSENTIALS PRODUCTS MUST BE INSTALLED AND USED IN ACCORDANCE WITH THEIR INSTRUCTIONS, INCLUDING INSTRUCTIONS PROVIDED WITH THE CHARGING ESSENTIALS PRODUCT PACKAGING OR PROVIDED ON THE PRODUCT ITSELF. AT THE DISCRETION OF CHARGING ESSENTIALS ANY DEFECTIVE PRODUCT WILL BE REPLACED OR THE PURCHASE PRICE REFUNDED. THIS WARRANTY SHALL IN NO EVENT EXCEED AMOUNTS PAID BY CUSTOMER TO CHARGING ESSENTIALS OR ITS AFFILIATES FOR THE CHARGING ESSENTIAL PRODUCTS INVOLVED, AND EXPRESSLY EXCLUDES COVERAGE OF ANY DAMAGE TO THIRD PARTY PRODUCTS OR ELECTRONICS.

Made in China

All trade names are registered trademarks of respective manufacturers listed. iOS is a trademark or registered trademark of Cisco in the U.S. and other countries. Apple, the Apple logo, iPad, iPhone, and iPad touch are trademarks of Apple Inc., registered in the U.S. and other countries. App store is a service mark of Apple Inc., registered in the U.S. and other countries. Android is a trademark of Google LLC. Google, Google Play, the Google Play logo, Google Assistant and the Google Assistant logo are trademarks of Google LLC. Amazon, Alexa and all related logos are trademarks of Amazon.com, Inc. or its affiliates. Wi-Fi® is a registered trademark of Wi-Fi Alliance®.